



17 Normandy Way

Ashford, TN23 5LN

Price £325,000

A well appointed end of terrace home arranged over three floors in a peaceful cul de sac position. The property comprises an entrance hall, utility & cloakroom, sitting room, kitchen/dining room, three bedrooms and bathroom/WC. Gas central heating and double glazing are installed with further benefits including an enclosed rear garden, garage and driveway. Ideally located for popular local schools, convenient shops, transport links and nearby countryside walks.

- END OF TERRACE HOME
- ARRANGED OVER THREE FLOORS
- THREE BEDROOMS
- UTILITY & CLOAKROOM
- KITCHEN/DINING ROOM
- GARAGE & DRIVEWAY
- CUL DE SAC POSITION
- POPULAR SCHOOLS NEARBY
- GAS CENTRAL HEATING & DOUBLE GLAZING

Viewing

Please contact our Ashford Office on 01233 646411 if you wish to arrange a viewing appointment for this property or require further information.



Floor Plan

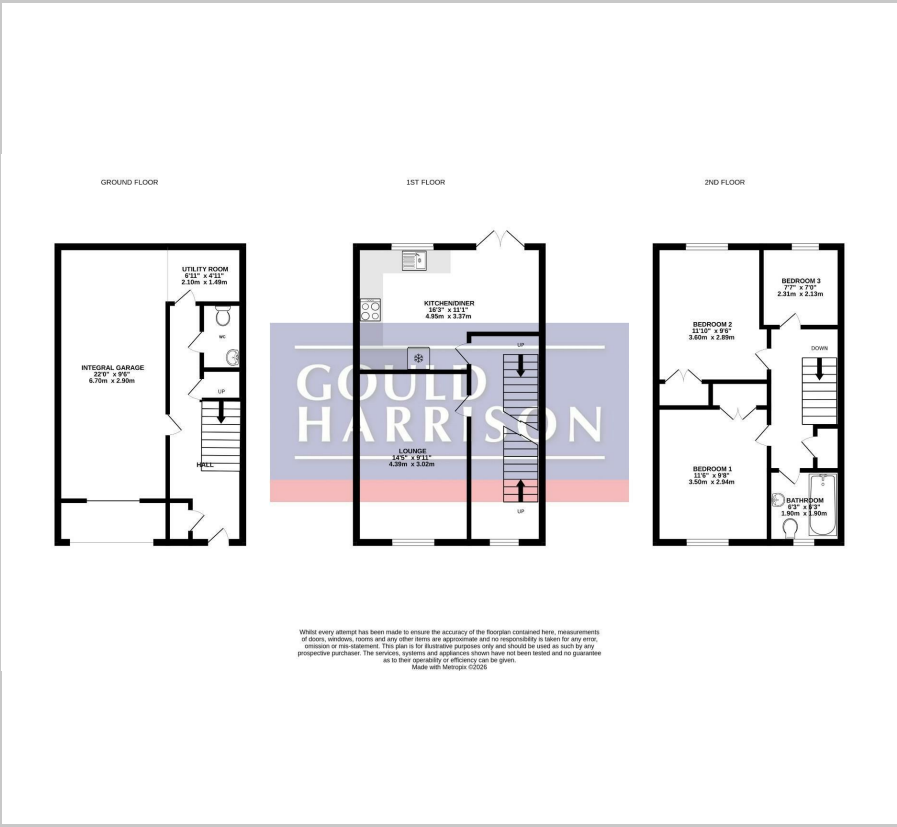

Area Map



Energy Efficiency Graph

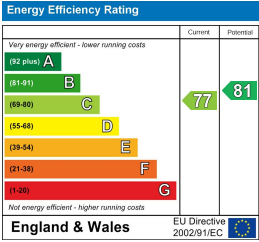

These particulars, whilst believed to be accurate are set out as a general outline only for guidance and do not constitute any part of an offer or contract. Intending purchasers should not rely on them as statements of representation of fact, but must satisfy themselves by inspection or otherwise as to their accuracy. No person in this firm's employment has the authority to make or give any representation or warranty in respect of the property.